



QUICK START

monoTIG Series



(+90) 444 93 53
magmaweld.com
info@magmaweld.com

 (+90) 538 927 12 62



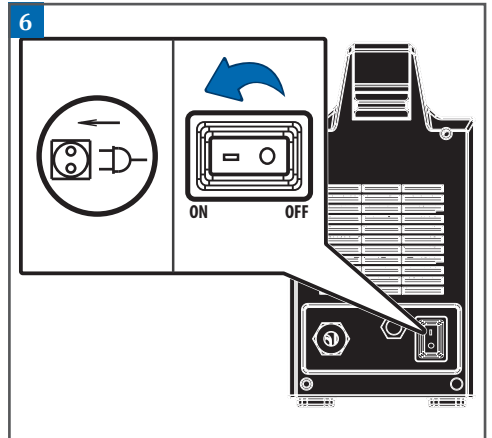
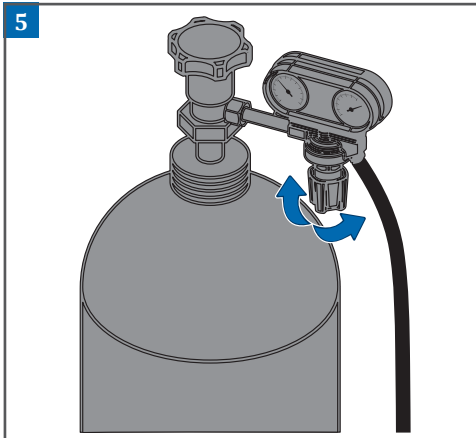
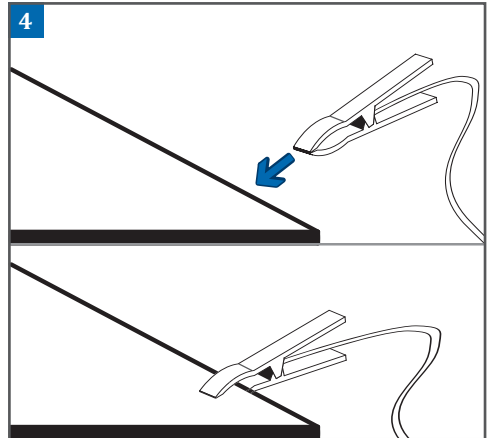
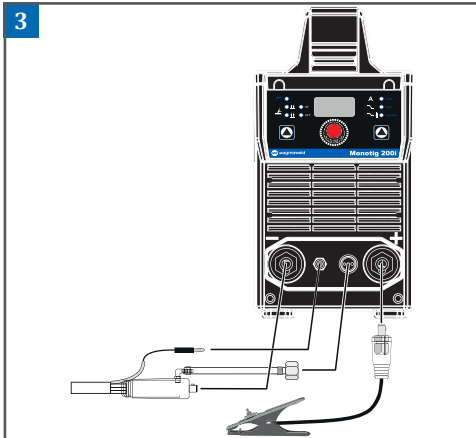
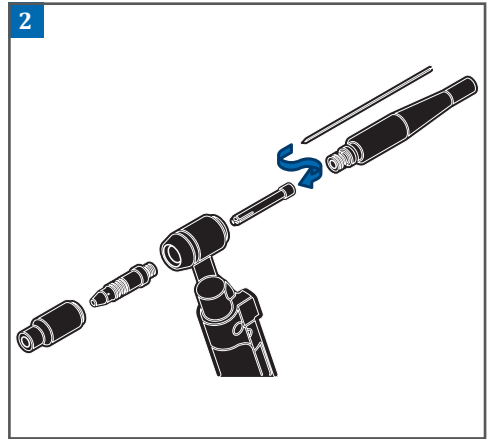
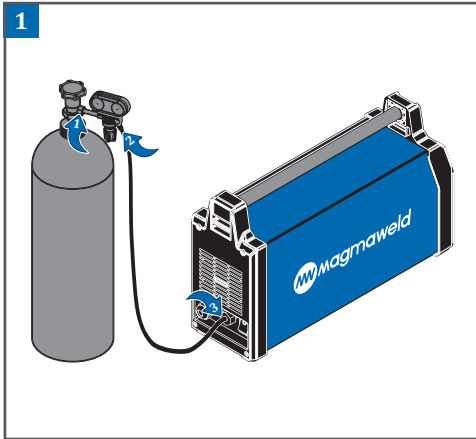

7 MMA

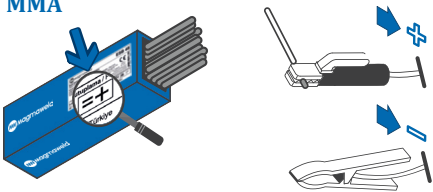
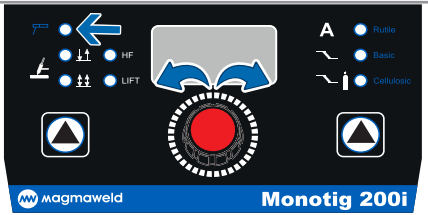
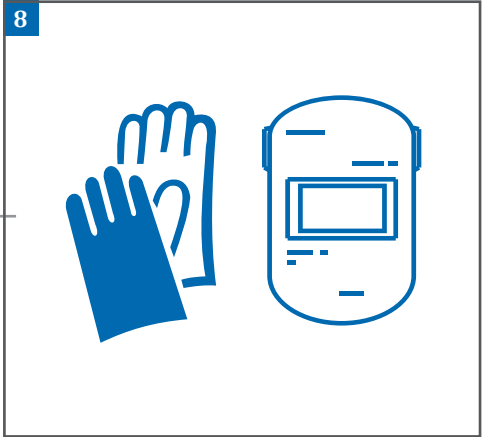

Illustration of the Magmaweld MMA electrode box and the TIG torch with the electrode inserted. The box is blue and labeled 'Magmaweld' and 'MMA'. The torch is black and silver.



Control panel of the Monotig 200i power source. It features a large red dial in the center, a blue arrow pointing left, and various control buttons and indicators. The panel is labeled 'Magmaweld' and 'Monotig 200i'.



9



Warranty Form
Garanti Formu



QR code for the warranty form.

10

monoTIG 160i monoTIG 200i



QR codes for the monoTIG 160i and monoTIG 200i manuals.